

ACCOMMODATIONS SYMBOL LEGEND

- ▲ Twin Bed and Single Sofa Bed
- ★ 2 Twin Beds (convert to King) and Single Sofa Bed
- 2 Twin Beds (convert to King) and 1 Upper Pullman
- ⋮ 2 Twin Beds (convert to King) and 2 Upper Pullmans
- 2 Twin Beds (convert to King), Single Sofa Bed and 1 Upper Pullman

- † 2 Twin Beds (convert to King) and Double Sofa Bed
- ▼ 2 Twin Beds (convert to King), Single Sofa Bed and 2 Upper Pullmans. Beds do not convert to King when both Upper Pullmans in use.
- ◆ Stateroom with 2 Porthole Windows
- ◁ Connecting staterooms (ideal for families and groups of friends)
- ✱ Twin Beds do not convert to a King Bed
- U Unisex Wheelchair Accessible Restroom

6L 6M JS Staterooms and suites with obstructed views: 1440, 1459, 2448, 2473, 9205, 9206.

All accommodations are non-smoking.
Accessible staterooms are available for guests with disabilities. Please contact Guest Access Services at 1-800-438-6744 ext. 70025 for details, or visit <http://www.carnival.com/about-carnival/special-needs.aspx>.

CATEGORIES

- 1A Interior Upper/Lower
 - PT Porthole
 - 4A 4B 4C 4D 4E 4F 4G 4H Interior
 - 4I Interior with Picture Window (obstructed views)
 - 6A Ocean View
 - 6L 6M 6N Deluxe Ocean View
 - 7C Cove Balcony
 - 8A 8B 8C 8D 8E 8F 8G Balcony
 - 8M 8N Aft-View Extended Balcony
 - 9C Premium Vista Balcony
 - JS Junior Suite
 - OS Ocean Suite
 - GS Grand Suite
 - 4S Interior 6S Ocean View (obstructed views) 8P 8S Balcony SS Suite
- Spa accommodations include private access, special amenities and priority reservations at the Cloud 9 Spa.

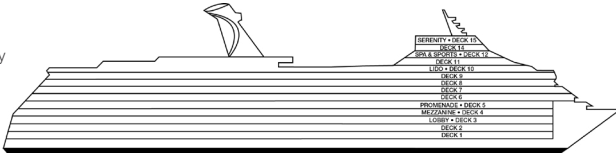

Gross Tonnage: 130,000 Length: 1,004 Feet Beam: 122 Feet
Cruising Speed: 20 Knots Guest Capacity: 3,690 (Double Occupancy)
Total Staff: 1,367 Registry: Panama

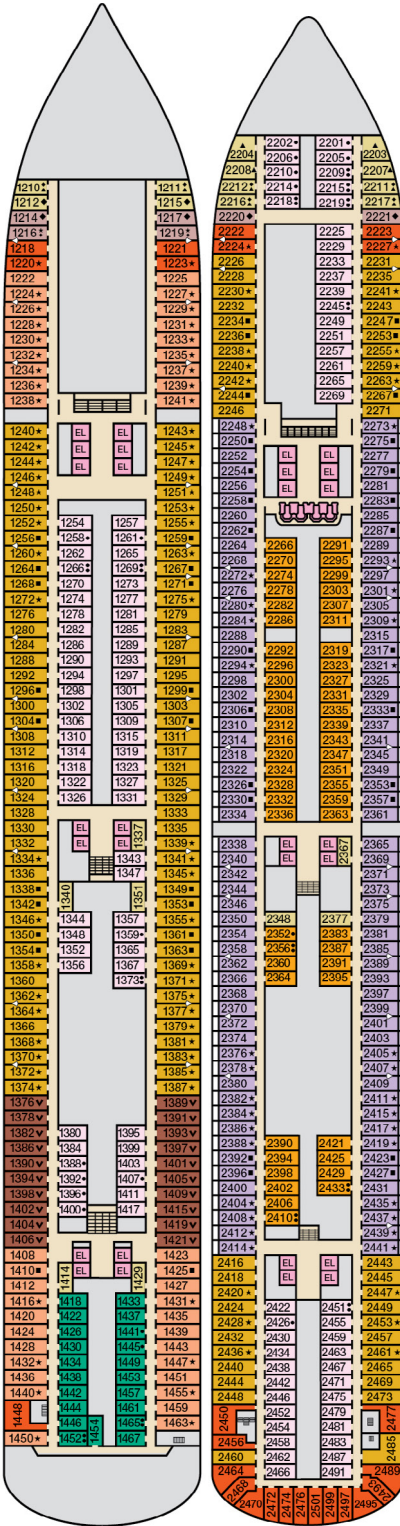

Deck 1

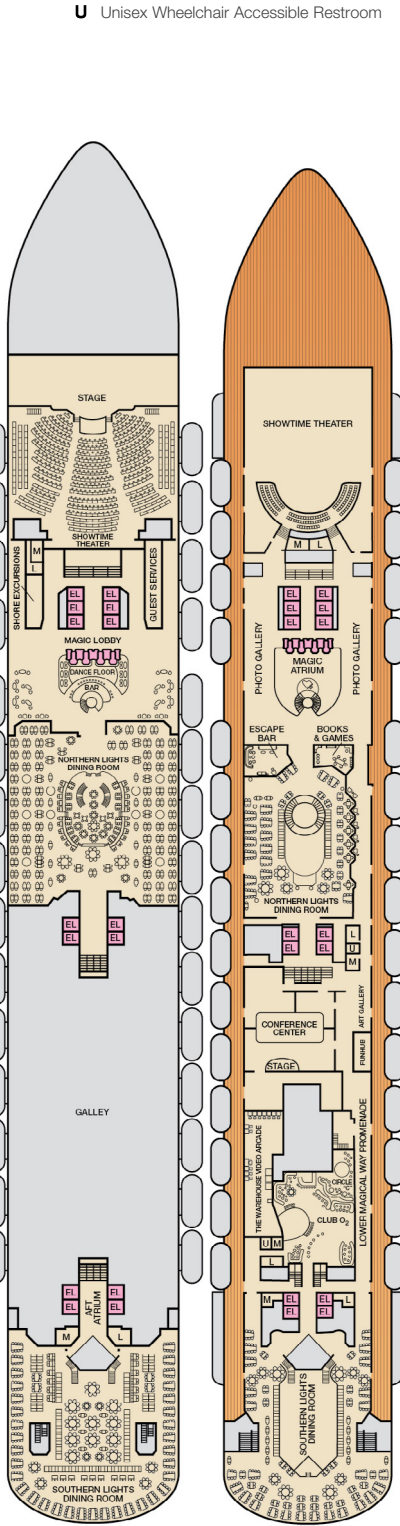

Deck 2

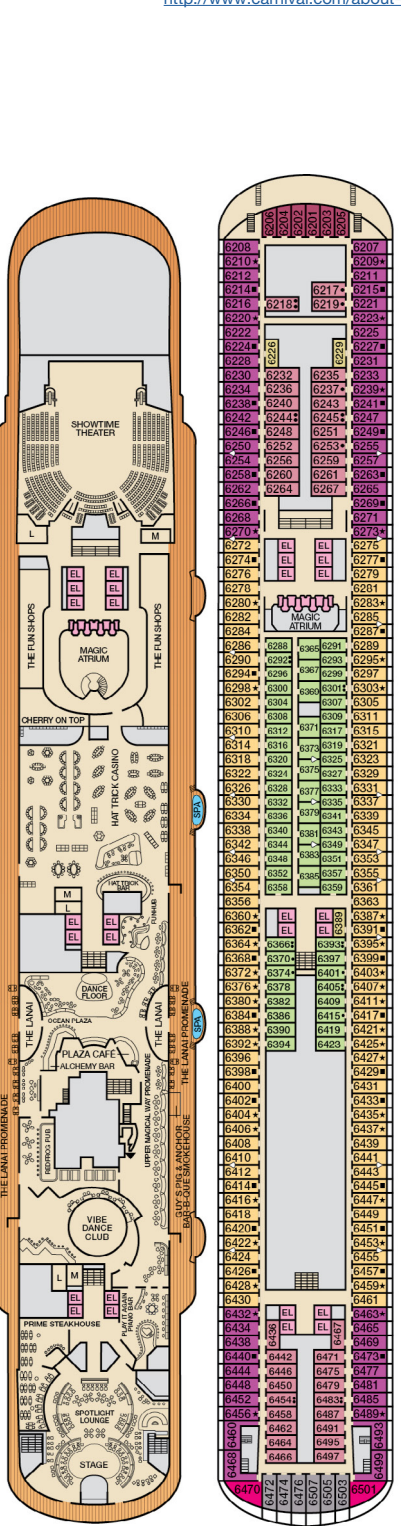

Lobby • Deck 3



Mezzanine • Deck 4



Promenade • Deck 5

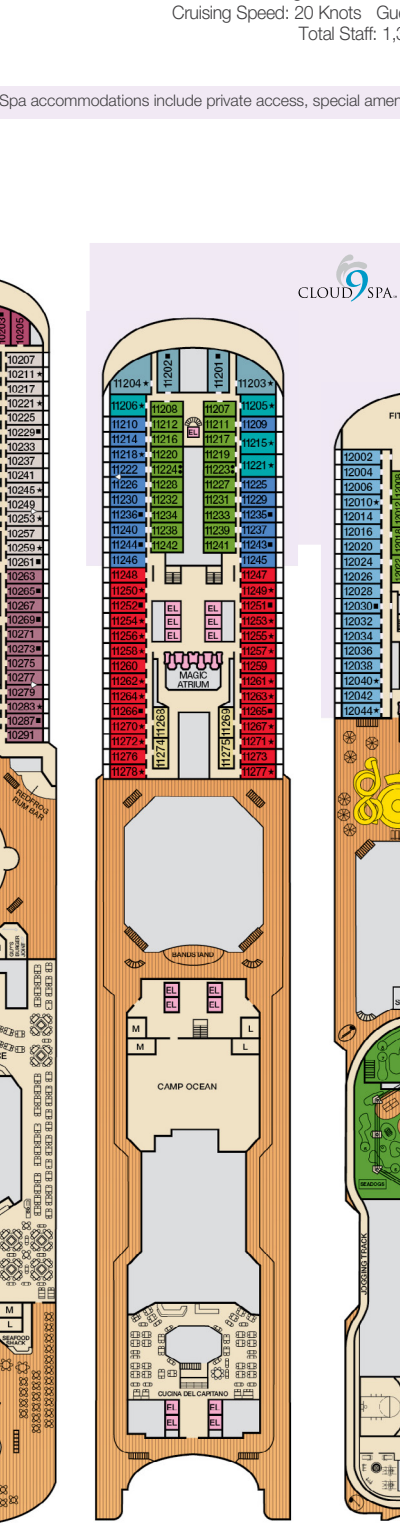

Deck 6

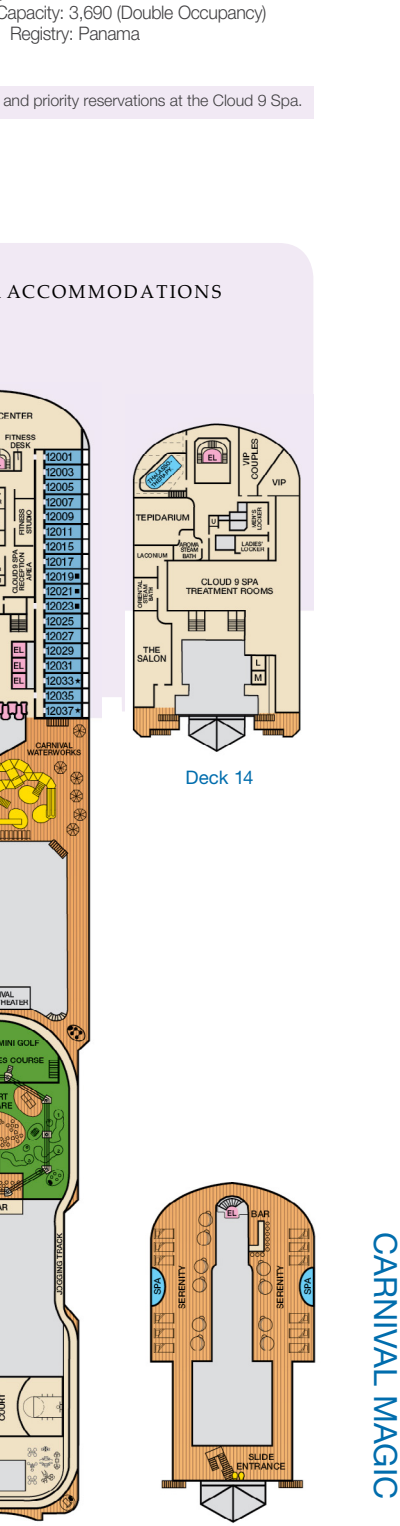

Deck 7



Deck 8

Deck 9

Lido • Deck 10

Deck 11

Spa & Sports • Deck 12

Serenity • Deck 15

ACCOMMODATIONS SYMBOL LEGEND

- ▲ Twin Bed and Single Sofa Bed
 - ★ 2 Twin Beds (convert to King) and Single Sofa Bed
 - 2 Twin Beds (convert to King) and 1 Upper Pullman
 - 2 Twin Beds (convert to King) and 2 Upper Pullmans
 - 2 Twin Beds (convert to King), Single Sofa Bed and 1 Upper Pullman
 - † 2 Twin Beds (convert to King) and Double Sofa Bed
- ▼ 2 Twin Beds (convert to King), Single Sofa Bed and 2 Upper Pullmans
 - ◆ Stateroom with 2 Porthole Windows
 - ◊ Connecting staterooms (ideal for families and groups of friends)
 - ✱ Twin Beds do not convert to a King Bed.
 - U Unisex Wheelchair Accessible Restroom
 - 🚭 All accommodations are non-smoking.
- Accessible Routes including Ramps
 - Restrooms, Elevators, Lifts and other Accessible Areas
 - Fully Accessible Staterooms (FAC)
 - Fully Accessible Staterooms - Single Side Approach (FAC-SSA)
 - Ambulatory Accessible Staterooms (AAC)

DECK PLANS

Please contact Guest Access Services for specific ship accessibility features. You may also visit <http://www.carnival.com/about-carnival/special-needs.aspx>

Spa accommodations include private access, special amenities and priority reservations at the Cloud 9 Spa.

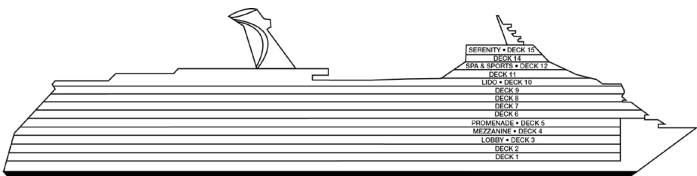

Gross Tonnage: 130,000 Length: 1,004 Feet Beam: 122 Feet Cruising Speed: 20 Knots
Guest Capacity: 3,690 (Double Occupancy) Total Staff: 1,367 Registry: Panama

